

External Laydown Threading Inserts

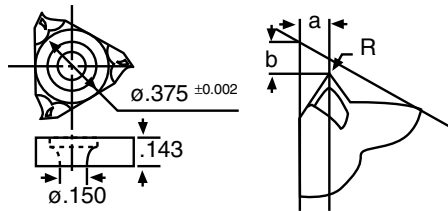

General Info

Negative Inserts

Positive Inserts

Ace-Fix Inserts

Threading, Grooving, & Cut-Off Inserts

Ceramic Inserts

PCBN & PCD Inserts

Toolholders

Swiss Toolholders

Boring Bars

Technical Info

ALMT

Full Profile (ISO Metric)

Cat No.	Pitch/mm	Threads/inch	Stock Grade				R	Included Angle θ°	a	b
			Uncoated	Coated		Cermet				
			A30	EH20Z	AC225	T130A				
TME100R	1.00	—	•	•	•	•	.0050	60	.031	.047
TME125R	1.25	—	•	•	•	•	.0067		.031	
TME150R	1.50	—	•	•	•	•	.0080		.039	
TME175R	1.75	—	•	•	•	•	.0094		.047	
TME200R	2.00	—	•	•	•	•	.0106		.055	
TME250R	2.50	—	•	•	•	•	.0140		.071	
TME300R	3.00	—	•	•	•	•	.0165		.071	

Full Profile (Inch)

Cat No.	Threads/inch	Pitch/mm	Stock Grade				R	Included Angle θ°	a	b
			Uncoated	Coated		Cermet				
			A30	EH20Z	AC225	T130A				
TUE24R	24	—	•	•	•	•	.0047	60	.031	.047
TUE20R	20	—	•	•	•	•	.0059		.039	
TUE18R	18	—	•	•	•	•	.0067		.047	
TUE16R	16	—	•	•	•	•	.0079		.055	
TUE14R	14	—	•	•	•	•	.0091		.071	
TUE12R	12	—	•	•	•	•	.0110			
TUE08R	8	—	•	•	•	•	.0169			

Partial Profile (60°)

Cat No.	Pitch/mm	Threads/inch	Stock Grade				R	Included Angle θ°	a	b
			Uncoated	Coated		Cermet				
			A30	EH20Z	AC225	T130A				
TME1020R	1.0~2.0	24~12	•	•	•	•	.005	60	.043	.047
TME1530R	1.50~3.00	16~8	•	•	•	•	.008		.063	.039

Partial Profile (55°)

Cat No.	(Inch)	Threads/inch	Stock Grade				R	Included Angle θ°	a	b
			Uncoated	Coated		Cermet				
			A30	EH20Z	AC225	T130A				
TWE1410R	—	14~10	•	•	•	•	.009	55	.055	.047
TWE2416R	—	24~16	•	•	•	•	.005			

Internal Laydown Threading Inserts

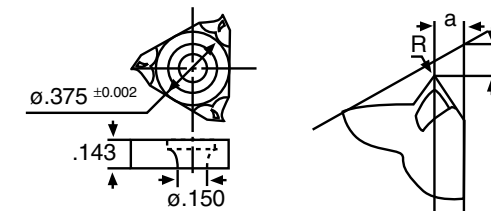

General Info

Negative Inserts

Positive Inserts

Ace-Fix Inserts

Threading, Grooving, & Cut-Off Inserts

Ceramic Inserts

PCBN & PCD Inserts

Toolholders

Swiss Toolholders

Boring Bars

Technical Info

ALMT

Full Profile (ISO Metric)

Cat No.	Pitch/mm	Threads/inch	Stock Grade				R	Included Angle θ°	a	b
			Uncoated	Coated		Cermet				
			A30	EH20Z	AC225	T130A				
TMI100R	1.00	—	•	•	•	•	.0024	60	.031	.047
TMI125R	1.25	—	•	•	•	•	.0030		.031	
TMI150R	1.50	—	•	•	•	•	.0035		.039	
TMI175R	1.75	—	•	•	•	•	.0043		.047	
TMI200R	2.00	—	•	•	•	•	.0050		.055	
TMI250R	2.50	—	•	•	•	•	.0063		.071	
TMI300R	3.00	—	•	•	•	•	.0080		.071	

Partial Profile (60°)

Cat No.	Pitch/mm	Threads/inch	Stock Grade				R	Included Angle θ°	a	b
			Uncoated	Coated		Cermet				
			A30	EH20Z	AC225	T130A				
TMI 1020R	1.00~2.00	24~12	•	•	•	•	.0024	60	.039	.047
TMI 1530R	1.50~3.00	16~8	•	•	•	•	.0035		.060	

Full Profile (NPT)

Cat No.	Pitch/mm	Threads/inch	Stock Grade				R	Included Angle θ°	a	b
			Uncoated	Coated		Cermet				
			A30	EH20Z	AC225	T130A				
TNPT115R		11.5	•	•	•	•	.004	60	.059	.043

Indexable Inserts For Threading

THREADING INSERTS

General Info	TNMA		Coated			Cermet			Uncoated			Dimensions (Inches)				Insert Hole
	NV		T1200A									Inscribed Circle	Thickness	Nose Radius	Insert Hole Dia.	
Negative Inserts	Sumitomo Cat. No.	New ISO Cat. No.														Application
	TNMA 32 NV	—									3/8	1/8	.004	.150	—	
Positive Inserts	TNMA 43 NV	—									1/2	3/16	.004	.2031		
	TNMA 54 NV	—									5/8	1/4	.004	.250		

Ace-Fix Inserts	TPMA		Coated			Cermet			Uncoated			Dimensions (Inches)				Insert Hole
	NV		T1200A									Inscribed Circle	Thickness	Nose Radius	Insert Hole Dia.	
Threading, Grooving, & Cut-Off Inserts	Sumitomo Cat. No.	New ISO Cat. No.														Application
	TPMA 32 NV	—									3/8	1/8	.004	.150	—	
Ceramic Inserts	TPMA 43 NV	—									1/2	3/16	.004	.2031		
	TPMA 54 NV	—									5/8	1/4	.004	.250		

PCBN & PCD Inserts	TNMC		Coated			Cermet			Uncoated			Dimensions (Inches)				Insert Hole
	NV		T1200A									Inscribed Circle	Thickness	Nose Radius	Insert Hole Dia.	
Toolholders	Sumitomo Cat. No.	New ISO Cat. No.														Application
	TNMC 32 NV	—									3/8	1/8	.004	.150	—	
Swiss Toolholders	TNMC 43 NV	—									1/2	3/16	.004	.2031		
	TNMC 54 NV	—									5/8	1/4	.004	.250		
TNMC 64 NV	—										3/4	1/4	.004	.3126		

Boring Bars	TPMC		Coated			Cermet			Uncoated			Dimensions (Inches)				Insert Hole
	NV		T1200A									Inscribed Circle	Thickness	Nose Radius	Insert Hole Dia.	
Technical Info	Sumitomo Cat. No.	New ISO Cat. No.														Application
	TPMC 32 NV	—									3/8	1/8	.004	.150	—	
ALMT	TPMC 43 NV	—									1/2	3/16	.004	.2031		
	TPMC 54 NV	—									5/8	1/4	.004	.250		
TPMC 64 NV	—										3/4	1/4	.004	.3126		